



WEST CENTRAL AREA COMMITTEE



AGENDA

To: City Councillors: Smith (Chair), Tucker (Vice-Chair), Bick, Cantrill, Holland, Ratcliffe, Reid and Reiner

County Councillors: Cearns and Nethsingha

City and County Councillor: Hipkin

Dispatched: Wednesday, 15 April 2015

Date: Thursday, 23 April 2015

Time: 7.00 pm

Venue: St Augustine's Church, Richmond Road, Cambridge, CB4 3PS

Contact: Claire Tunnicliffe **Direct Dial:** 01223 457013

1 Apologies

2 Declarations of Interest

Members of the committee are asked to declare any interests in the items on the agenda. In the case of any doubt, the advice of the Head of Legal should be sought **before the meeting**.

3 Minutes

To confirm the minutes of the meeting held on 05 March 2015.
(Minutes to Follow)

4 Matters and Actions arising from the Minutes

5 Police and Crime Commissioners Outreach Worker: 7.05pm

Rebecca Avery, the Police and Crime Commissioners Outreach Worker, will be present to explain her role and will be present to discuss her role and that of Sir Graham Bright in his capacity as the Police and Crime Commissioner and the Police and the Crime plan.

Questions to Rebecca will be taken in the Open Forum.

- | | | |
|-----------|--|---------------|
| 6 | Open Forum:
Refer to the 'Information for the Public' section for rules on speaking. | 7.10pm |
| 7 | Policing & Safer Neighbourhoods:
(Pages 5 - 16) | 7.40pm |
| 8 | Area Committee Grants 2015/16 :
(Pages 17 - 26) | 8.10pm |
| 9 | St Augustine's Church Hall - Improvements to Community Facilities - Capital Grant:
(Pages 27 - 34) | 8.30pm |
| 10 | Streetlight Replacement Programme in Cambridge Central:
To welcome representatives from Balfour Beatty who will give a presentation on the streetlight replacement programme in Cambridge Central. | 8.40pm |
| 11 | Environmental Data Reports:
(Pages 35 - 64) | 9.10pm |
| 12 | West Central Area Committee Dates 2015/16 | |

The Committee is asked to agree the following meeting dates:

Wednesday 8 July 2015

Wednesday 30 September 2015

Thursday 03 December 2015

Thursday 11 February 2016

Tuesday 12 April 2016.

Members are asked to contact the Committee Manager in advance of the meeting with any comments regarding the above dates.

Meeting Information

Open Forum Members of the public are invited to ask any question, or make a statement on any matter related to their local area covered by the City Council Wards for this Area Committee. The Forum will last up to 30 minutes, but may be extended at the Chair's discretion. The Chair may also time limit speakers to ensure as many are accommodated as practicable.

Filming, recording and photography The Council is committed to being open and transparent in the way it conducts its decision making. The public may record (e.g. film, audio, tweet, blog) meetings which are open to the public.

Anyone who does not want to be recorded should let the Chair of the meeting know. Those recording meetings are strongly urged to respect the wish of any member of the public not to be recorded.

Fire Alarm In the event of the fire alarm sounding please follow the instructions of Cambridge City Council staff.

Facilities for disabled people Level access is available at all Area Committee Venues.

A loop system is available on request.

Meeting papers are available in large print and other formats on request prior to the meeting.

For further assistance please contact Democratic Services on 01223 457013 or democratic.services@cambridge.gov.uk.

Queries on reports If you have a question or query regarding a committee report please contact the officer listed at the end of relevant report or Democratic Services on 01223 457013 or democratic.services@cambridge.gov.uk.

**General
Information**

Information regarding committees, councilors and the democratic process is available at <http://democracy.cambridge.gov.uk/>

Mod.Gov App

You can get committee agenda and reports for your tablet by using the mod.gov app

Neighbourhood profile update Cambridge City West/Central Neighbourhood

April 2015



**Matt Johnson, Safer
Neighbourhoods
Inspector**

**Lynda Kilkelly, Safer
Communities Manager,
Cambridge City Council**



Creating a safer
Cambridgeshire



**CAMBRIDGE
CITY COUNCIL**

1 INTRODUCTION	2
Aim	
Methodology	
2 CURRENT PRIORITIES	3
3 PRO-ACTIVE WORK & EMERGING ISSUES	9
4 ADDITIONAL INFORMATION	10
Current Crime & ASB Incident Levels by Ward	
Environmental Services Data	
5 RECOMMENDATIONS	12

1 INTRODUCTION

Aim

The aim of the Neighbourhood profile update is to provide an overview of action taken since the last reporting period, identify ongoing and emerging crime and disorder issues, and provide recommendations for future priorities and activity in order to facilitate effective policing and partnership working in the area.

The document should be used to inform multi-agency neighbourhood panel meetings and neighbourhood policing teams, so that issues can be identified, effectively prioritised and partnership problem solving activity undertaken.

Methodology

This document was produced using the following data sources:

- Cambridgeshire Constabulary crime and anti-social behaviour (ASB) incident data for December 2014 to March 2015, compared to the previous like reporting period (August to November 2014) and the same reporting period in 2013/14.
- City Council environmental services data for the period December 2014 to March 2015, compared to the same reporting period in 2013/14; and
- Information provided by the Safer Neighbourhood Policing team and the City Council's Safer Communities team.

2 CURRENT PRIORITIES

At the West/Central Area Committee meeting of 07 January 2015, the committee recommended adopting the following priorities:

- Address alcohol related violent crime and ASB
- Tackle Cycle Theft
- Address a range of road safety issues including parking, inconsiderate cycling, driving and speeding.

The Neighbourhood Action Group, at its meeting of 26 January 2015, assigned the actions to be taken and lead officers for each of the priorities. The tables below summarise the actions taken and the current situation.

Alcohol related violent crime and anti-social behaviour	
Objective	To continue to tackle Alcohol Related Violent Crime and Anti-Social Behaviour
Action Taken	<p>Alcohol related violence and ASB in the West / Central areas can broadly be broken down into two areas: issues related to the night time economy and issues related to street drinking.</p> <p>Night time economy</p> <p>Issues relating to night time economy are being monitored through the Alcohol Related Violent Crime (ARVC) group which comprises of police and partners.</p> <p>Through the ARVC, we have enhanced our weekend “Operation Connect”; briefings are conducted together with Street Pastors and Door Staff and others, and briefings are shared with CCTV operators.</p> <p>Sgt Wood is developing “Operation Standing”; this is where Licensed Premise Staff in Cambridge City Centre will be provided with “Alcoblw” breathalysers in order to assess the level of intoxication of potential customers – hopefully going some way to deter the “pre-loading” phenomenon and dissuade intoxicated customers from trying to enter licenced premises. Trials in Birmingham and Norfolk boast significant reductions in arrests, paramedic call-outs and ASB, with no detrimental impact on local businesses. We ran a local trial at ‘The Junction’ on 12th March 2015, which hosted an Under 18’s Night where Door-staff were loaned a trial Alcoblw device. Staff reported that 30 young people were refused entry due to</p>

failing the test, and many more didn't even join the queue when they saw tests being carried out. By comparison, six ambulances were called out during the same event the previous year, so the early indications are good.

The ARVC is working on other projects to enhance the safety and prevent crime and ASB particularly in the Market Ward.

The reporting period covered the Christmas and New year period which as you would expect was very busy and the custody block at Parkside dealt with 14 detained people between 8:30pm on New Year's Eve and 6:30am New Year's Day. As a point of interest the first person arrested in 2015 was arrested for biting someone at 2:30am on Rose Crescent.

Street drinking and related ASB

As well as the work done around the night time economy we continued to work with our partners to address other forms of street based ASB such as Street Drinking and Begging. Over the winter period we have continued to process a number of people to court for the offence of begging, and this continues to be part of a process where we are working towards other court orders such as Criminal Behaviour Orders to address and manage peoples' behaviour.

As well as taking an enforcement based approach to issues such as begging and street drinking we are now in the final planning stages of the Alternative Giving campaign around begging in the city which is being carried out in partnership with the City Council and a number of their support agencies across the homelessness sector in the City. This work continues to be supported by our colleagues in the Special Constabulary who in the run up to Christmas carried out direct patrols against begging which were very successful and they continue to support the work of Op Connect.

We are also currently working with the University of Cambridge and a number of our partners in planning for Caesarean Sunday, the Pre-exam event for students which takes place on Jesus Green, and we are hopeful that the event will pass with a minimum number of issues as it did last year.

Other ASB

Sgt Wood has been attending bi-monthly meetings with the City Council to discuss wider issues affecting the City Centre,

	<p>which has evolved into street briefings and accompanied patrols with members from the City Centre Policing Team. We have also recently started some engagement work with Parkside School to warn pupils and parents about the dangers of alcohol and drug abuse, and have supported Grafton Security in moving on groups of troublesome youths.</p> <p>In a bid to address the reported ASB in Sussex street (now colloquially referred to as 'Spanish Corner' on account of it being a preferred meet-up point for Spanish Students), we have scheduled a meeting with businesses and residents at the end of the month. We are continuing patrols in this area at all times of the week, and have been assessing the effectiveness of previous crime-prevention techniques (e.g. such as displaying warning notices in Spanish). Our Crime Prevention Manager has been tasked to conduct a site-survey of the area, and I have been looking to introduce an additional mobile CCTV camera to help accurately assess the scope of the problem.</p>
Current Situation	<p>Work through the ARVC to address alcohol fuelled crime is ongoing and there are a number of strands of work which are being developed. It should be noted that as the weather improves, it is likely that we will see ASB shift towards open green spaces.</p> <p>Additionally, whilst not alcohol related, the spring / summer months see an increase in visitors to the city and an increase in unlicensed punt touts. The unlicensed put touts have historically been involved in anti-social behaviour.</p>
Lead Officer	Sergeants Kevin Misik and Ian Wood, Cambridgeshire Constabulary

Cycle theft	
Objective	To continue to tackle cycle theft
Action Taken	There continue to be reports of cycle crime across the whole of the area and we continue to work to identify patterns in offending and Hot Spot areas of crime. Once these patterns have been identified we have had some success as a result of targeting our patrols at the relevant time and place. One example of this has been a male who was coming to an area on Grange Road with a regular pattern to steal cycles and

	<p>cycle parts. As a result of members of the West team changing their duties to address the issue a male was arrested and has subsequently been charged with 9 cycle theft related offences from within the area. He has pled guilty at this point and we are waiting to find out what sentence he will be given.</p> <p>In continuing with our approach to dealing with hot spot's the team PCSOs have conducted both high profile patrols in areas where large numbers of pedal cycles are parked and there have been recent offences such as the junction of Downing Street and St Andrews street. This tactic has been supported by work by Police Officers in plain clothes to deal with offenders, again targeting high profile locations.</p> <p>We continue to work with the wider Cambridge district teams to address handlers of stolen cycles across the wider city.</p>
Current Situation	<p>Again, this is a long term issue; whilst the figures indicate a significant reduction of offences, the summer will bring many visitors who may not take necessary precautions together with new students arriving at the end of the summer.</p>
Lead Officer	<p>Sergeants Kevin Misik and Ian Wood, Cambridgeshire Constabulary.</p>

Operation Safe Passage¹	
Objective	Address road safety issues for all road users
Action Taken	<p>During the reporting period we have continued to carry out a range of traffic based activity. This ranges from dealing with cyclists who have ridden through red lights to speed checks at a number of locations across the area.</p> <p>Following the success of the LIT scheme in the previous reporting period we have continued to deal with a number of students who still don't have lights following concerns being expressed by a number of colleges. As well at this the City Centre PCSOs have been working to ensure that people are cycling in the right direction and in an appropriate manner on the streets within the historic city centre.</p> <p>There has been a number of speed checks carried out across</p>

¹ This priority draws together all road safety elements previously referred to under earlier wider road safety priority.

	<p>the area to address speeding motorists. We are currently recruiting volunteers from the community for SpeedWatch – initial induction and training is due in April and we will update at the next Area Committee meeting.</p> <p>The PCSOs have also been carrying out enforcement action around the issue of obstruction, particularly on the small side streets which suffer from an increase number of issues at the weekend.</p> <p>As well as the work carried out by the officers within the Problem Solving Teams we are supported by the Special Constabulary and the Safer Neighbourhood Teams as part of Operation Safe Passage. This is an ongoing operation which targets areas of the city which have suffered from serious injury or fatal Road Traffic collisions. Since the last meeting in January, there have been 583 Traffic Offence Reports (city-wide, not just West / Central) for a variety of offences.</p>
Current Situation	We are currently focusing on trying to develop and support the SpeedWatch programme across the City.
Lead Officer	Sergeant Ian Wood, Cambridgeshire Constabulary

3 PRO-ACTIVE WORK & EMERGING ISSUES

- Burglary Dwelling - By comparison to the previous four month period dwelling burglary has seen an overall reduction of 48% or 13 fewer offences. This also represents 5 fewer offences against this same period in 2013/14. With reductions across all three wards the most significant were seen in both Newnham and Market wards.
- Non-Dwelling Burglary – By comparison to the previous four month period non-dwelling burglary has seen an overall increase of 33% or 12 more offences. With Newnham showing a reduction both Castle and Market wards have seen an increase of 5 and 11 offences respectively.
- All Violent Crime - By comparison to the previous four month period AVC has seen an overall increase of 16% or 29 more offences. With Castle and Market wards relatively stable there was an increase from 2 to 13 offences recorded in Newnham. This increase for Newnham is also significantly higher than in than this same reporting period in 2013/14 which saw 3 offences.

- Robbery - By comparison to the previous four month period robbery has seen an overall reduction of 58% or 7 fewer offences. The most significant reduction was seen in Market ward with 6 fewer offences and once again no robberies were recorded in the Newnham ward. This overall figure remains lower than in this same period in 2013/14.
- Theft of Vehicle – Only 4 vehicles have been stolen during this reporting period and this crime type remains stable against both the previous reporting period and this same period in 2013/14.
- Theft from Vehicle - By comparison to the previous four month period theft from vehicle has seen an overall reduction of 56% or 30 fewer offences. The most significant reduction was seen in the Newnham ward which saw 28 fewer offences.
- Theft of Pedal Cycle – By comparison to the previous four month period theft of pedal cycle has seen a significant reduction of 43% or 175 fewer offences. This reduction was seen across all three wards with the Market ward seeing 137 fewer offences.
- Theft from shop – By comparison to the previous four month period this crime type has remained stable with just two further offences recorded. This overall figure remains 16% or 39 offences lower than in the same reporting period 2013/14
- Total Crime – By comparison to the previous four month period, at 1256 offences there has been a reduction of 13% or 194 fewer offences overall. This figure is also slightly lower than in this same reporting period 2013/14.
- ASB – By comparison to the previous four month period, at 254 there has been a reduction of 36% or 143 fewer incidents overall. This figure is also 76 incidents or 23% lower than in this same reporting period 2013/14.
- The City Council’s Safer Communities team has dealt with two reports in Market ward, one regarding street life issues and the other regarding a cycle theft. Advice was given and the appropriate departments / agencies were contacted. The team also dealt with one report in Castle ward involving a complaint of racial harassment which resulted in a case being opened and the City Council’s Community Cohesion and Racial Harassment Officer leading on it. From his investigation and intervention, there have been no more incidents reported and the case is being monitored.

4 ADDITIONAL INFORMATION

CURRENT CRIME & ASB INCIDENT LEVELS BY WARD

			Dwelling Burglary	Other Burglary	Violent Crime	Robbery	Theft of Vehicle	Theft from Vehicle	Cycle Theft	Theft from Shop	Criminal Damage	Other Crime	TOTAL CRIME	TOTAL ASB
AREA	City West/Central	Dec 14 – Mar 15	14	48	210	5	4	24	229	198	84	440	1256	254
		Dec 13 – Mar 14	19	28	146	8	4	38	229	237	46	517	1272	330
		Aug 14 – Nov 14	27	36	181	12	5	54	404	200	81	450	1450	397
WARDS	Castle	Dec 14 – Mar 15	8	14	13	1	0	7	20	0	10	22	95	32
		Dec 13 – Mar 14	10	6	5	1	1	9	36	3	4	34	109	31
		Aug 14 – Nov 14	10	9	11	2	2	12	39	0	8	24	117	38
	Newnham	Dec 14 – Mar 15	3	10	13	0	2	8	24	1	11	27	99	19
		Dec 13 – Mar 14	4	9	3	2	0	21	31	2	3	31	106	11
		Aug 14 – Nov 14	9	14	2	0	1	36	43	3	5	42	155	30
	Market	Dec 14 – Mar 15	3	24	184	4	2	9	185	197	63	391	1062	203
		Dec 13 – Mar 14	5	13	138	5	3	8	162	232	39	452	1057	288
		Aug 14 – Nov 14	8	13	168	10	2	6	322	197	68	384	1178	329

ENVIRONMENTAL SERVICES DATA

Castle

Abandoned vehicles

- December 2014 to March 2015: 1 report, which included 1 vehicle not on site following inspection
- Hotspots: None
- December 2013 to March 2014: 7 reports

Fly tipping

- December 2014 to March 2015: 5 reports (1 inspection with no evidence found), which included
 - 0 formal warning letters issued to domestic offenders
 - 0 formal warning letters issued to trade offenders
 - 0 verbal warnings
 - 3 request for waste transfer documentation from trade offenders
- Hotspots: None
- December 2013 to March 2014: 8 reports

Derelict cycles

- December 2014 to March 2015: 12
- Hotspots: All Saints Passage - 3
- December 2013 to March 2014: 9

Needle finds

- December 2014 to March 2015: 3 – grass verge near Stapes (1), grounds at St Giles Church, Castle Street (2)
- Hotspots: None
- December 2013 to March 2014: 2

Newnham

Abandoned vehicles

- December 2014 to March 2015: 3 reports (1 pending further investigation), which included
 - 1 vehicle not on site following inspection
 - 1 vehicle subsequently claimed by their owner
 - 0 CLE26 notices issued to offenders on behalf of the DVLA for not displaying road tax on a public highway
 - 0 vehicles impounded on behalf of the DVLA for not having valid road tax
 - 0 vehicles subsequently destroyed following non-payment of the DVLA fine
 - 0 vehicles held pending further investigation
- Hotspots: None

- ❑ December 2013 to March 2014: 14 reports

Fly tipping

- ❑ December 2014 to March 2015: 9 reports (1 inspection with nothing found), which included
 - 0 formal warning letters issued to domestic offenders
 - 1 formal warning letter issued to trade offenders
 - 0 verbal warnings
 - 1 request for waste transfer documentation from trade offenders
- ❑ Hotspots: None
- ❑ December 2013 to March 2014: 19 reports

Derelict cycles

- ❑ December 2014 to March 2015: 12
- ❑ Hotspots: None
- ❑ December 2013 to March 2014: 12

Needle finds

- ❑ December 2014 to March 2015: 15 and 1 knife
- ❑ Hotspots: Grounds of St Edwards King and Martyr church, St Edwards Passage (15 and 1 knife)²
- ❑ December 2013 to March 2014: 0

Market

Abandoned vehicles

- ❑ December 2014 to March 2015: 0 reports
- ❑ Hotspots: None
- ❑ December 2013 to March 2014: 1 report

Fly tipping

- ❑ December 2014 to March 2015: 19 reports (6 ongoing investigations and 1 unable to trace suspect), which included
 - 3 formal warning letters issued to domestic offenders
 - 0 formal warning letters issued to trade offenders
 - 0 verbal warnings
 - 0 requests for waste transfer documentation from trade offenders
- ❑ Offences at Miltons Walk accounted for 3 of the formal warning letters sent
- ❑ Hotspots: None
- ❑ December 2013 to March 2014: 43 reports

Derelict cycles

- ❑ December 2014 to March 2015: 71

² These were reported from the church warden on 5 occasions directly to Streets & Open Spaces: 6th Feb (1), 19th Mar (3), 21st Mar (4), 26th Mar (6), 31st Mar (1)

- Hotspots: Drummer Street (4), Jesus Lane (3)
- December 2013 to March 2014: 64

Needle finds

- December 2014 to March 2015: 22 – New Square (20), rear of Burleigh House on Newmarket Road (1), alley way at Napier Street (1)
- Hotspots: New Square (20)³
- December 2013 to March 2014: 2

5 RECOMMENDATIONS

- To target alcohol related violent crime and ASB
- To target ASB caused by punt touts in Market Ward

³ An estimate of 20 needles which was found as a pack of used needles in a sealed container found by an operative who was litter picking on the grassed area at New Square



To: **West /Central Area Committee - 23rd April 2015**
 Report by: Jackie Hanson
 Community Funding & Development Manager
 Communities, Arts & Recreation Service
 Wards affected: Castle, Market, Newnham

AREA COMMITTEE COMMUNITY GRANTS 2015-16

1. Executive summary

1.1 This report details applications received to date for 2015-16 funding for projects in the West/Central Area, makes recommendations for awards and provides information on the eligibility and funding criteria.

2. Recommendations

The West/Central Area Committee Councillors are recommended:

- 2.1 to consider the grant applications received, officer comments and proposed awards detailed in Appendix 1, in line with the Area Committee Community Grants criteria detailed in paragraph 3.3.3.
- 2.2 to agree the proposed awards detailed in Appendix 1 and summarised in the table below:

Ref	Organisation	Purpose	Award £
WC1	CAMS Music Trust	Bursaries for music activities	0
WC2	Christ's Pieces Residents' Association	Talks for local residents	140
WC3	Friends of Midsummer Common	Community Orchard projects and maintenance	405
WC4	St Augustine's Church with Richmond, Oxford and Windsor Road Residents' Associations	2 all day social events ;12 Friday night talks and 6 Saturday evening concerts	1,500
WC5	St Augustine's Church	Weekend events programme celebrating new community facilities	500
WC6	St Giles' Church	Annual Christmas tree festival	367
WC7	Sustrans	Pageant and train volunteer walk	1,000

		leaders to run regular free social walks in the area	
WC8	Under-fives Roundabout	2 wildlife and outdoor discovery trips	300

Budget available	£11,000
Total awards	£4,212
Budget remaining	£6,788

3. Background

3.1 Management

3.1.1 Funding has been devolved to Area Committees for local projects meeting the Community Development, Sports or Arts strategic priorities since 2004. This process is managed by the Grants Team in Communities, Arts and Recreation who promote the funding and bring applications for consideration to one meeting of each of the area committees annually.

3.1.2 The 2015-16 grants were publicised, via neighbourhood workers, in local publications and voluntary organisations newsletters, by posters and publicity leaflets and previous applicants were also invited to apply. Over 30 organisations attended briefings held to explain the application process and revised eligibility criteria and priorities. (See 3.3.3)

3.2 Funding Available

3.2.1 There is a total of £80,000 available across the four area committees for 2015-16 made up as follows:

- £60,000 Community Grants
- £20,000 Safer City

3.2.2 The budgets have been divided between the area committees in accordance with population and poverty calculations. The Safer City allocation has provided £5,000 for each area committee. The amount available for each area is as follows:

Committee	Community Grants %	Community Grants £	Safer City £	Total available £
North	37.8	22,680	5,000	27,680
East	32.2	19,320	5,000	24,320
South	20	12,000	5,000	17,000
West Central	10	6,000	5,000	11,000
Total	100	60,000	20,000	80,000

3.3 Eligibility Criteria and Funding Priorities

3.3.1 In July 2014 the Community Services Scrutiny Committee considered new priorities and outcomes for community, arts and recreation development funding which was agreed by the Executive Councillor for Community, Arts and Recreation. This new funding programme is named 'Community Grants'.

3.3.2 In addition to the Community Grants priorities the Area Committee Grants also have priorities reflecting the financial contribution made from the Safer City budget.

3.3.3 Projects and activities should have a targeted approach and make a difference to people in one of the areas (North, South, East or West Central) by either:

- reducing social or economic inequality or
- tackling crime, the fear of crime or anti-social behaviour

and they must meet one of our funding priorities below:

- sporting activities
- arts and cultural activities
- community development activities
- legal and/or financial advice (*Organisations applying to give legal advice and support must have The Advice Quality Standard (AQS) or equivalent*)
- employment support
- capacity building of the voluntary sector to achieve the above
- community projects aiming to tackle crime, the fear of crime or anti-social behaviour

3.3.4 Applications are invited from voluntary organisations, community groups and groupings of local residents that are able to meet basic accountability requirements.

3.3.5 The maximum any one organisation can apply for is £5,000 per area committee and grants cannot be made retrospectively. Full details of the eligibility criteria are available on request.

3.3.6 All awards are subject to funding agreements and monitoring reports. We consider proportionate requirements dependent on the size of the organisation, project and award.

3.4 Year Round Applications

3.4.1 Applications made after the main grants round will be considered on an individual basis until all the funding is spent. Officers will make decisions

on awards up to £5,000 as approved by the Community Services Scrutiny in January 2014.

3.4.2 In December 2015 the area budgets will be merged and any funding remaining will be allocated across the areas as applications are received, to ensure effective use of the funds available.

3.5 **2014-15 Awards**

3.5.1 After the end of the financial year we will collect the monitoring reports for awards made during 2014-15 and circulate a summary to members. A list of awards to date for 2014-15 is attached as Appendix 2.

Appendix 1 – West/Central Area Committee Grant Applications and Recommendations 2015-16

Ref	Organisation	Purpose	Aim & disadvantage outcome	Beneficiaries	Budget	Bid £	Award £		
WC1	CAMS Music Trust	Up to 46 means related bursaries for children and families to enable them to take part in 4 out of school extra-curricular activities – 10 Sundays of Community Orchestra, Youth Choir, Music Club, Jazz Group	Proactively encourage no-barrier participation in extended musical activities. Bring communities of people together - particularly through the family aspect to improve mental and physical wellbeing. Improve access to music activities regardless of age, ability, ethnic group, disability and income level.	22 children (are parents extra?)	Full cost: £26,245 - project across the city. Income: £14,470 (plus AC South £4,605, AC East £4,995).	2,175	0		
								Officer comment	Recommend no award. The project is to enable children to take part in 'existing' extra-curricular music activities (+ one new activity) held at St Matthews Primary School and Centre at St Pauls. City-wide activity. East & South – no award approved
								Previous 2 years funding:	None
WC2	Christ's Pieces Residents Association	One talk for local residents in Unitarian Church	Increase the sense of community and help local people to know more about it. Reduce loneliness as some residents live alone and also increase resident's knowledge and understanding of the area	40-50 all ages	Full cost: £265 Income: £45	220	140		
								Officer comment	Recommend £140 contribution to cover hall hire and speaker fee
								Previous 2 years funding:	14-15: £300 13-14: £300

WC3	Friends of Midsummer Common	Community orchard activities and maintenance. (insurance, bat and bird boxes, mower costs, wildflower meadow establishment)	Improve the wellbeing of local people. Many live in flats or small houses without access to gardens. Many disadvantaged /lonely people use the space and join in the free activities. The working parties are inclusive and help to reduce social isolation and promote community spirit and well-being.	100 members plus unknown large number of visitors	Full cost: £860 Income: £455	405	405
	Officer comment	Recommend full amount					
	Previous 2 years funding: 14-15: £1458 13-14: £390						

Page 2

WC4	St Augustine's Church with Richmond, Oxford and Windsor Roads' Residents' Associations	2 all day social events, 12 Friday night talks and 6 Saturday evening concerts.	Social and educational activities available to as many residents as possible. Reduce isolation amongst elderly people, plus those from overseas working locally and develop cohesion between different communities living locally. Provide affordable and accessible activities to those unable to travel into the city due to reduced mobility or income	1000 all ages 300 W/Central	Full cost: £4,100 Income: £2,600	1,500	1,500
	Officer comment	Recommend full amount					
	Previous 2 years funding: 14-15: £1,500 13-14: £1,750						

Page 23	WC5	St Augustine's Church	Weekend programme of events "Open Door" to showcase the new community facilities at St Augustine's (March 2016)	Encourage participation in the range of activities at the venue and identify new needs and solutions. Reach out to those who may be unaware of the possibilities for them to participate in a range of activities at a cost tailored to their needs. Identity new activities that will contribute to tackling inequalities and other social issues.	300 all ages. 50 Arbury.	Full cost: £2,250 Income: £1,750	500	500
	Officer comment	Recommend full amount Building work partly funded by Section 106						
	Previous 2 years funding: 14-15: £1,500 13-14: £1,750							

WC6	St Giles' Church	Annual Christmas tree festival – 9 days. Up to 30 groups decorate a tree	To give pleasure to all who create the decorations for the trees, and who come in and visit the festival, at a time of year when many people feel especially isolated. The festival aims to make visitors feel part of a wider community.	325 North. 175 West Central	Full cost: £1,767 Income: £600 North approved £700	1,167	367	
Officer comment	Recommend £367. North approved £700.							
Previous 2 years funding: 14-15: £1,145 13-14: £1,099								

WC7	Sustrans	Recruit and train volunteer walk leaders to run a regular free social walk.	Provide regular opportunity for people to take part in a social activity, help elderly, less able or socially isolated residents to be more physically active, recruit and train volunteers to make a difference locally. Promote walking as an accessible (free and local) form of physical exercise for older people and those with mobility and health issues.	70 all ages but most likely older	Full cost: £2,140 Income: £1,140 (from reserves)	1,000	1,000
	Officer comment	Recommend full amount					
	Previous 2 years funding:	none					

WC8	Under-fives Roundabout	2 wildlife and outdoor discovery trips	Pre-school children experience the diversity of local wildlife and take part in new and challenging outdoor activities to broaden their experience of the world around them. Some would not normally access due to lack of transport and low income. 30-40% children live in social housing, have housing benefits or parents are in full time education,	24 children from Castle ward	Full cost: £855 Income: £0	855	300
	Officer comment	Recommend £300. High reserves and North Area Committee approved £100 contribution.					
	Previous 2 years funding:	14-15: £345 from WC					

Appendix 2 – 2014-15 Awards

Group	Purpose	Award £
Christ's Pieces Residents Association	Two talks	300
Friends of Midsummer Common	Community orchard equipment and events	1,133
Little Monkeys parent and toddler playgroup	Repair existing soft play equipment . <i>Plus contribution from NAC</i>	190
St Augustine's Church	A programme of 20 talks, concerts and events	1,500
St Giles Church	Sixth annual Christmas Tree Festival	1,145
Under Fives Roundabout	Two x 2hr wildlife and discovery sessions <i>Plus contribution from NAC</i>	345
Windsor Road Residents Association	Meetings, activities and events	200

This page is intentionally left blank

Project Appraisal

To	West / Central Area Committee
Report By	Bridget Keady
Project Name	St Augustine's Church Hall – Improvements to Community Facilities – Capital Grant
Committee	West / Central Area Committee
Committee Date	23 April 2015
Wards Affected	Castle

Project Appraisal and Recommendation

Recommendations

Financial recommendations -

- a) Subject to relevant planning approval and completion of the Council's Capital Grant Agreement members are asked to approve a capital grant of £87,000 to St. Augustine's Church in Castle Ward.
- b) There are no revenue or maintenance implications for the Council.

1 Summary

1.1 The project

The West/Central Area Committee on 07th January 2015, agreed to allocate the devolved S106 community facilities contributions that were available at that time, as a capital grant towards the side extension to the main hall at St Augustine's Church, subject to project appraisal and community use grant agreement.

Given that the updates on the availability of S106 contributions are rounded down to the nearest £25,000, it was known that the grant, at that time, would be at least £75,000.

It is now possible to confirm a grant of £87,000.

A further update on devolved S106 contributions will be made to the West/Central Area Committee later this year, as part of the fourth S106 priority-settings round. The building is shown at Appendix B and will form an extension to the side of the existing community facility.

Target Dates:	Note: these are provisional dates provided by St. Augustine's
Start of Procurement	May 2015
Award of Contract	June 2015
Start of project delivery	July 2015
Completion of project	October 2015

1.2 The Cost

Total Project Cost	£87,000
--------------------	---------

Capital Cost Funded from:

Funding:	Amount:	Details:
Reserves	£10,000	<i>(Have also applied to Amey Crespa for £20,000)</i>
Repairs & Renewals	£	
Developer Contributions	£87,000	<i>From West/Central's developer contributions programme – Confirmation from S106 Manager that monies available.</i>
Climate Change Fund		
Other		

Revenue Cost: Not applicable

1.3 The Procurement

The works will be procured and project managed by St Augustine's Church.

2 Capital Project Appraisal & Procurement Report

2.1 What is the project?

This project is to award a capital grant of £87,000 to St Augustine's Church towards improvements to their community facilities. The improvements comprise:

- A side extension to the main hall to provide additional meeting / event space.

The church has reserves of £10,000 and is actively fund raising to secure the remaining money. They have also applied to Amey Crespa for £20,000.

The building is used extensively by a range of community groups on a regular basis, and is also a venue for concerts, talks and other events, including children's parties and receptions. The current building has served the needs of the community for over a 100 years. The improvements will improve the quality and range of facilities on offer, and make better use of the space that is available, in order to make the building accessible to all. The church are looking forward to welcoming residents from the new community at Darwin Green.

2.2 The major issues for stakeholders & other departments

This project will significantly improve the range of community facilities at St. Augustine's Hall and will help to ensure the longer term viability of the hall through increased use and opportunities for income generation.

2.3 Summarise key risks associated with the project

The capital grant will be subject to St. Augustine's Hall finalising design drawings, obtaining planning permission and completing the Council's Capital Grant Agreement which will protect community access and ensure no groups wishing to use the facilities are discriminated against.

2.4 Financial implications

- a) Appraisal prepared on the following price base: 2015/16
- b) The Capital allocation of £87,000 will be paid in instalments in arrears on submission of an Architect's certificate and/or copies of invoices for work completed.
- c) There are no revenue or maintenance implications for the Council.

2.5 Capital & Revenue costs

(a) Capital	£	Comments
Building contractor / works	87,000	Estimated costs (not yet tendered)
Purchase of vehicles, plant & equipment		
Professional / Consultants fees		
IT Hardware/Software		
Other capital expenditure		
Total Capital Cost	87,000	

(b) Revenue	£	Comments
Total Revenue Cost	0	

2.6 VAT implications

There are no adverse VAT implications to this project

2.7 Environmental Implications

Climate Change Impact	-L
-----------------------	----

It is estimated that the overall project will have a low but negative environmental impact as the footprint will increase by around 46m². The building design will ensure that the environmental impact will be minimized.

2.8 Other implications

An EQIA has been done and no adverse impact was identified.

The new extension and toilet facilities will be fully accessible and the Capital Grant Agreement will ensure that the facilities are open to all community groups and individuals. St. Augustine's has indicated that they are keen to encourage older

people to come, and would like to have a café area in the lobby area (which is currently used for storage as it is not suitable as a community meeting space).

St. Augustine's has produced an outline programme which would deliver the finished project by October 2015.

2.9 Staff required to deliver the project

Legal support will be required to complete the Council's Capital Grant Agreement. The project will be monitored by staff in Community Development.

2.10 Identify any dependencies upon other work or projects

None

2.11 Background Papers

Report to West Area Committee on S106 developer contributions potential projects – 07th January 2015

2.12 Inspection of papers

Author's Name	Bridget Keady
Author's phone No.	01223 457878
Author's e-mail:	Bridget.keady@cambridge.gov.uk
Date prepared:	02.04.2015

Appendix A

	2015/16	Comments
	£	
Capital Costs		
Building contractor / works	87,000	Profile is estimate based on information from St. Augustine's Church
Purchase of vehicles, plant & equipment		
Professional / Consultants fees		
Other capital expenditure:		
Total Capital cost	87,000	
Capital Income / Funding		
Government grant		
Developer contributions	87,000	West / Central Community Facilities –
R&R funding		
Earmarked funds		
Existing capital programme funding		
Revenue contributions		
Total Income	87,000	
New Capital Bid	0	

Appendix B – Side Extension at St Augustine’s Church

Page 34

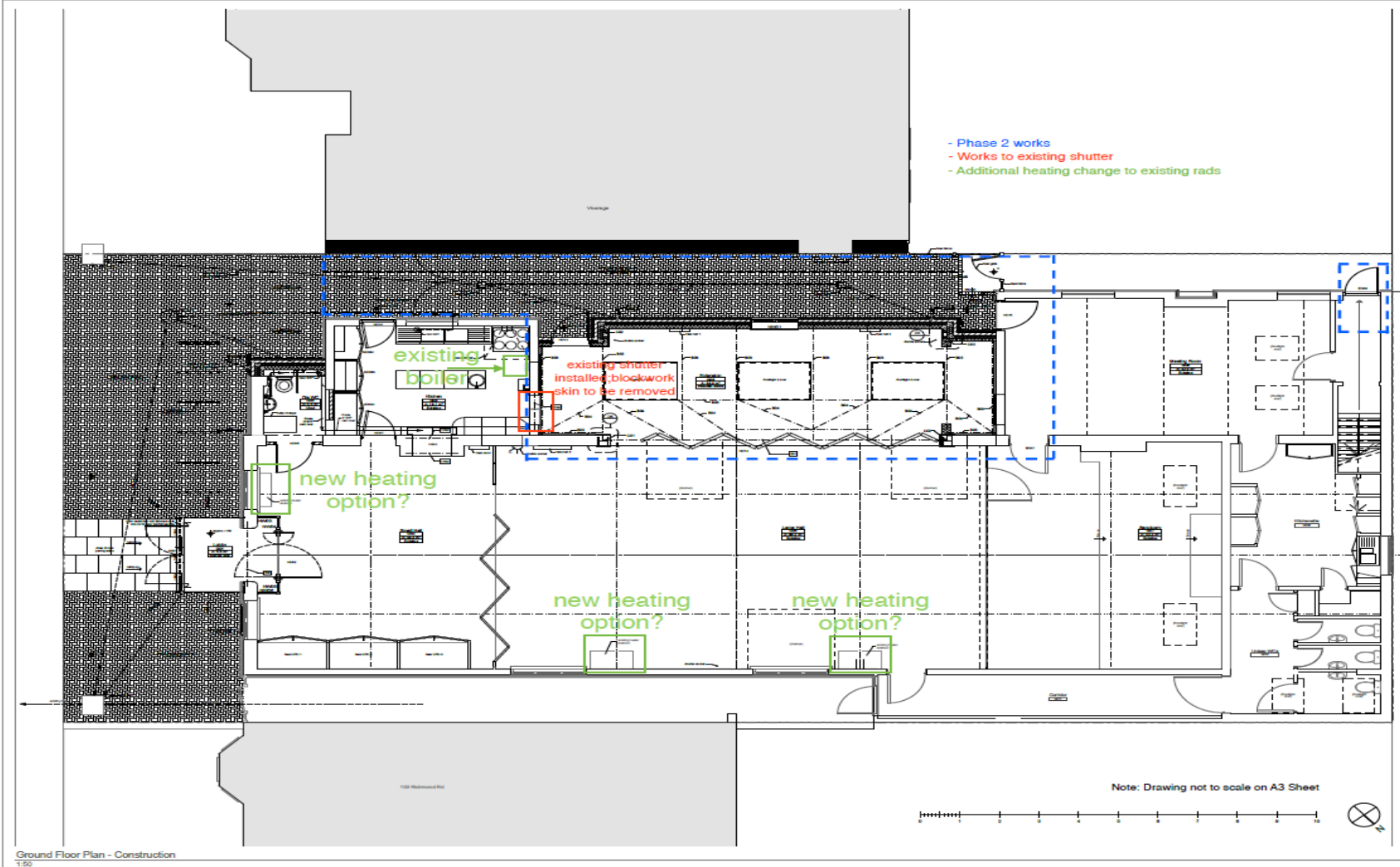

General notes
 1. Drawings must not be altered, work only to agreed dimensions.
 2. Drawings must be read in conjunction with all other relevant drawings, schedules and specifications for the project.
 3. All dimensions to be checked on site before and during construction by the Contractor.
 4. Shop drawings of manufactured items must be approved by the Architect before work is put to hand.
 5. The Architect must be notified of any discrepancies immediately.
 6. If in doubt ask!

© 2013 by the architect

3 Doctors Close
 Impington
 Cambridge
 CB4 3JG
 Tel: 01223 474917
 Mail: info@archangel.co.uk
 www.archangel.co.uk
 www.churchbuild.co.uk



CONSTRUCTION

Scale: 1:50
 Date: 12/12/13
 Drawn: JMB
 Checked: JMB
 Project: St Augustine's Church

Client: St Augustine's Church
 Mr Richard Footitt
 69 Richmond Road
 Cambridge
 CB4 3PS

Project number: 0311
 Drawing number: 0311 231
 Title: - GF Plan - Construction

Environmental Data Report



Cambridge West/Central Area
January to March 2015

Contents

1. Introduction	3
2. Target setting and recommendations	3
3. Routine activity	4
4. 'Ward Blitz' Update	4
5. Specific issues and actions	5
6. Private realm environmental data	9
Public realm environmental data	10
7. Proactive and community work	15
8. Key contacts	16
9. Resources	17
10. Appendices	20

1. Introduction

This quarterly report provides an overview of City Council Refuse and Environment and Streets and Open Spaces service activity relating to the geographical area served by the West/Central Area Committee. The report identifies the reactive and proactive service actions undertaken in the previous quarter, including the requested priority targets and reports back on the recommended issues and associated actions to be targeted in the following. It also includes key officer contacts for the reporting of waste and refuse and public realm issues.

2. Target setting and recommendations

All those at Committee have an opportunity to suggest issues that they would like to see tackled in the neighbourhood area during the upcoming quarter to help shape the activity to be undertaken within the public realm.

Following suggestions that are received the relevant teams will consider the suggestions, and will prioritise work, responding reactively where appropriate and programming some work for the future. All suggested targets will be reported back on in the following quarter to update members and the public on the status of the issue. Recommendations will also be presented to the committee for consideration and to aid discussion.

Recommendations

The following are suggestions for members on what action could be considered for priority within the West/Central Area for the quarter of January to March 2015.

Continuing priorities¹

1. Enforcement and City Ranger patrols in the City Centre to address issues of illegally deposited trade waste
Justification: There has been an increase from 3 to 8 cases of trade waste being illegally deposited in the Market ward and this recommendation is included to continue to balance the high standard of trade waste management already existing in the West/Central area.
2. *Keep the Trumpington Street runnels to a standard of cleanliness and keep them switched on during the summer months*
Justification: The runnels are maintained by the County Council as part of the public highway, but the switch on and cleanliness is managed by the City Council Streets and Open Spaces.
3. Early morning dog warden patrols for dog fouling on Grantchester Street and Lammas Land
Justification: Dog fouling continues to be identified by the Dog Warden and a number of individuals spoken to were not aware of dog control orders, this recommendation is included as a balance of education and enforcement

New suggested priorities

4. Investigate the bin provision at Grantchester Meadows and seek to improve the bins provided for both litter and dog mess in the car park area and approaches to the open space.
Justification: Current bin provision at the location has not been previously looked at as part of the city wide streets and parks litter bin project.
5. Proactive small scale graffiti and flyposting removal by City Rangers across the West/Central area

¹Amendments to continuing priorities are shown in italics

Justification: Work already conducted by the City Rangers has been positive and enhanced the areas where cleared. This recommendation is to continue this work as a priority for the Rangers covering the West/Central areas.

6. Enforcement patrols to address the issue of litter at Garrett Hostel Lane

Justification: Recent reports have been received by the Council for enforcement action to be taken against individuals who litter in this area.

Members are recommended to endorse the above recommendations or to make proposed amendments, and in doing so to consider the community intelligence questions below to help shape the public realm work.

Community intelligence questions

1. What activities should be considered as part of ward blitzes?
2. What geographical locations would benefit from targeted work? (including public realm enforcement activity and clean-up work by the community payback)
3. What locations for new and replacement general waste, recycling and dog bins (in line with resources available) should be considered?
4. Where and when the dog warden service should patrol in order to target dog fouling?.

3. Routine activity

Streets and Open Spaces teams work closely with residents, community and campaign groups to keep Cambridge clean, green and safe. Street cleansing works to clear shop fronts and maintain all residential streets to a good standard of cleaning by sweeping them regularly. The team empties litterbins and dog bins across the city parks and open spaces, as well as removing graffiti and clearing needles and fly tipping.

The grounds maintenance team maintains all council housing and highway grass and shrub beds across the city, and carries out the maintenance of the city's cemeteries and crematoriums as well as the maintenance of all parks across the city. The City Rangers team provide a street-level, face-to-face contact point for people to raise any cleanliness and public safety issues that they might have concerning their neighbourhood.

The dog warden patrols within Cambridge to increase people's awareness of the requirement to clear up after their pets, as well as collecting stray dogs within the city and works alongside animal charities to deliver educational roadshows. Investigation of instances of environmental crime in public places across the city is carried out by the public realm enforcement team. As well as undertaking enforcement action where necessary, the team provide advice for residents and businesses on issues including fly tipping, litter, waste, illegal advertising, abandoned shopping trolleys, verge parking and abandoned, untaxed and nuisance vehicles.

4. 'Ward Blitz' activity

The City Council has embarked on a campaign of monthly 'ward blitzes' across the City, involving the Council's City Rangers, Rapid Response, Public Realm Enforcement and Street Cleansing teams. These teams will undertake coordinated public realm maintenance, enforcement and educational action, targeting one ward every month in rotation. Working within existing budgets, this action is additional to the routine, day-to-day, work undertaken by these services.

In the West/Central Area, the first ward blitz programme will take place in Castle during February 2015 and will involve the following actions:

- Deep cleansing of gulley's
- Cleansing of litter and dog bins
- Cleansing of signage
- Cleansing of recycling centres
- Increased dog warden presence
- Increased public realm enforcement presence
- Joint working with Cambridgeshire Fire and Rescue, and Cambridgeshire Police
- Free dog microchipping event
- Proactive inspections by pest control in known hotspots

Reports on the results of the 'ward blitz' activity will be presented to Area Committees, who will also have the opportunity to recommend specific issues to be considered for targeting in forthcoming 'ward blitzes'.

The results of the Castle ward blitz are included in the appendices of this report. Future ward blitzes for the East Area are scheduled for West/Central area are scheduled for Market in June 2015 and Newnham in October 2015.

5. Specific issues and actions

The following specific issues were identified for targeted action in the January to March 2015 quarter. The following tables summarise the action undertaken and current situation, whether ongoing or completed, for each issue.

Priority 1	Enforcement and City Ranger patrols in the City Centre to address issues of illegally deposited trade waste
Action Taken	Over 70 hours of patrols were undertaken by the public realm teams to address the issues of trade waste illegally deposited during the period of January to March. As part of this process 12 statutory notices for businesses not managing their waste correctly were reissued and educational advice provided to owners, management and staff.
Current Situation:	Ongoing

Priority 2	Pressure wash and cleanse of the public recycling points at Castle Park, Park Street, Adam and Eve Street and Lammas Land, Histon Road, and the shops around Windsor Road and the runnels on Trumpington Street
Action Taken	All of the four public recycling centres were cleansed in the West/Central area during January, which involved a team of two operatives and took approximately 8 hours to complete.
Current Situation:	Completed
Action Taken	The shop fronts at Histon Road were cleansed and pressure washed which involved a team of two operatives and took approximately 8 hours to complete during January. .
Current Situation:	Completed
Action Taken	Cleansing of the city runnels has been carried out in January/February period and is due again before the runnels are switched on for the summer months.
Current Situation:	Ongoing

Priority 3	Deep cleanse of Garrett Hostel Lane, from Queens Road to Trinity Lane, including Burrell's Walk area to include the removal of graffiti, illegal flyposting, dog fouling, vegetation cut back and sweeping.
Action Taken	The whole of Snakey Path and the Tins from Burnside into the South area has been cleansed. This involved a team of two operatives and took approximately 7 hours to complete.
Current Situation:	Completed

Priority 4	Early morning dog warden patrols for dog fouling on Grantchester Street and Lammas Land
Action Taken	Dog warden patrols have been conducted by both the Enforcement team and Dog Warden Service to address the issues of dog fouling at the above locations, patrol times totalled 15 hours. Educational advice and dog bags have been provided to a number of early morning dog walkers seen at these locations and a fixed penalty was issued to an individual failing to clear up dog fouling on Lammas Land.
Current Situation:	Ongoing

Priority 5	Enforcement and City Ranger monitoring of Milton's Walk for domestic waste and fly tipping issues
Action Taken	Patrols have been conducted to address the issues of domestic waste illegally deposited at Milton's Walk, and during February two suspects were identified. These individuals have been provided warning letters and directed on the correct disposal of waste management. No further instances of fly tipping have been found at the location.
Current Situation:	Completed

Other issues

Issue	Fitzroy Street and Paradise Street: Cleansing frequency
Action Taken	The frequency at which this location is cleansed has been increased from twice a week to three times a week.
Current Situation:	Completed

Issue	Can dog bins with foot pedals be considered in future?
Action Taken	Bins with foot pedals attract children to them, which is why they are not traditionally used, we can consider this for future dog bin purchases
Current Situation:	Completed

Issue	Huntingdon Road – pink sacks not being picked up quickly enough
Action Taken	The Street Cleansing operative for this area starts his day here and leaves his bags on the side of the road for collection as he has a walking round; It is different bags that people are seeing on different days. It is possible that people will see bags there at the same time at least 3 times a week, so naturally think they have not collected. This situation is being monitored.
Current Situation:	Ongoing

6. Environmental Data

Private Realm (West/Central Area)

Activity	Investigations	Treatments Carried out	Informal Action / Written Warnings	Statutory Notices Served	Simple Cautions	Legal Proceedings	Comment
Pest Control	19	19	0	0	0	0	.
Noise Complaints (residential)	2	na	*	0	0	0	*All complaints will generally have at least one such action.
Refuse/Waste Complaints	0	na	*	0	0	0	*All complaints will generally have at least one such action.
Other public health complaints ²	1	na	*	0	0	0	*All complaints will generally have at least one such action.
Private Sector housing standards	11	na	*	1	0	1 being prepared	*All complaints will generally have at least one such action.

Summary of private realm data:

Lammas Land has been proactively inspected following positive rodent sightings associated with the open space. Lammas Land was inspected between October and February with 2 or 3 visits taking place each month until 16th February 2015 showing the infestation as eradicated. As these treatments appear to have been successful, new areas will now be targeted to assess the level of proactive treatment in the yet to be selected areas. It is proposed to target at least one area within each of the 4 Area Committee locations

² Other public health complaints includes odour, smoke, bonfires, filthy and verminous

Public Realm Data

Public Realm Enforcement (Castle)

Activity	Investigations	Written Warnings	Statutory Notices Served	Fixed Penalty Notices Issued	Simple Cautions	Legal Proceedings	Comment
Abandoned vehicles	3	n/a	n/a	0	0	0	Includes on untaxed and two abandoned vehicles.
Nuisance vehicles ³	0	0	n/a	0	0	0	
Derelict cycles	10	n/a	n/a	n/a	n/a	n/a	
Domestic waste	2	1	0	1	0	0	
Trade waste	0	0	0	0	0	0	
Litter	4	0	0	3	0	0	
Dog control orders (including fouling)	0	0	n/a	0	0	0	
Illegal camping	0	n/a	0	n/a	0	0	
Illegal advertising	7	6	n/a	0	0	0	

Summary of Castle public realm enforcement data

- Three abandoned vehicles inspections were carried out in the January to March period, but no vehicles were seized as abandoned and were either removed from the location or claimed by their owners.
- Ten derelict cycles were removed from across Castle. The number of cycles removed as abandoned in this area varies between 5 to 15 a quarter.
- There were two domestic waste investigations conducted in the area between January and March, which resulted in one warning letter, and one fixed penalty issued for littering at a recycling centre.
- Three fixed penalty were issued for depositing litter from a motor vehicle in Castle, including two on Madingley Road and one case is currently ongoing.
- Seven incidents of illegal advertising were identified; the majority of the advertising was illegally displayed estate agent boards, and were removed by the agents once informed on the issue. The other individuals cases were first time offenders and received written warnings about illegal advertising.

³ Nuisance vehicles includes vehicles displayed for sale or being repaired (other than in an emergency) on the public highway

Public Realm Enforcement (Market)

Activity	Investigations	Written Warnings	Statutory Notices Served	Fixed Penalty Notices Issued	Simple Cautions	Legal Proceedings	Comment
Abandoned vehicles	2	n/a	n/a	0	0	0	
Nuisance vehicles	0	0	n/a	0	0	0	
Derelict cycles	63	n/a	n/a	n/a	n/a	n/a	
Domestic waste	4	3	0	0	0	0	
Trade waste	20	5	12	0	0	0	
Litter	15	0	0	13	0	1	
Dog control orders (including fouling)	0	0	n/a	0	0	0	
Illegal camping	0	n/a	0	n/a	0	0	
Illegal advertising	16	15	n/a	0	0	0	

Summary of Market public realm enforcement data

- Two abandoned vehicle inspections were carried out in the January to March period, but no vehicles were seized as abandoned.
- Sixty three derelict cycles were removed from across the Market Ward. The number of cycles removed as abandoned in this area varies between 10 to 75 a quarter.
- There were four domestic waste investigations conducted in the area between January to March, which resulted in three warning letters and in one case no evidence was recovered.
- Trade waste from eight businesses was found illegally dumped in and around the ward, including four incidents of dumping waste on Wellington Street and All Saints Passage. Evidence from seven businesses was identified, and all businesses complied with the requests from enforcement regarding their compliance for waste duty of care and five written and two verbal warnings were issued. Twelve statutory notices for storing and disposing of waste in the Market ward were reissued to businesses.
- Thirteen fixed penalty notices were issued for depositing related litter in the Market ward between January and March, which included two incidents on Burleigh Street and three on Parkside. There is currently one case ongoing, and one case has legal proceedings being instigated for non-payment.
- Sixteen incidents of illegal advertising were identified; the majority of the advertising was illegally displayed on the railings of Jesus Green Parkers Pieces and Christ Pieces, and were removed by the Council. Those responsible were first time offenders and received written warnings about illegal advertising.

Public Realm Enforcement (Newnham)

Activity	Investigations	Written Warnings	Statutory Notices Served	Fixed Penalty Notices Issued	Simple Cautions	Legal Proceedings	Comment
Abandoned vehicles	5	n/a	n/a	0	0	0	Includes one untaxed and four abandoned vehicles.
Nuisance vehicles	0	0	n/a	0	0	0	
Derelict cycles	8	n/a	n/a	n/a	n/a	n/a	
Domestic waste	0	0	0	0	0	0	
Trade waste	1	0	0	0	0	0	
Litter	2	0	0	1	0	0	
Dog control orders (including dog fouling)	1	0	n/a	1	0	0	
Illegal camping	0	n/a	0	n/a	0	0	
Illegal advertising	2	2	n/a	0	0	0	

Summary of Newnham public realm enforcement data

- Five abandoned vehicles inspections were carried out in the January to March period, two vehicles were seized as abandoned, one of which was destroyed when no owner could be traced. One untaxed vehicle was removed from Adams Road, and was claimed by the owner upon payment of the DVLA release fees.
- Eight derelict cycles were removed from across Newnham. The number of cycles removed as abandoned in this area varies between 5 to 15 a quarter.
- Trade waste from one business was found illegally dumped on Kings Parade. Evidence from a business was identified, and they complied with the request from enforcement regarding their compliance for waste duty of care and received a verbal warning.
- One fixed penalty was issued for depositing cigarette related litter on Barton Road and subsequently paid, and a further case of litter from a motor vehicle is currently ongoing. .
- One case of failing to clear up dog fouling was witnessed by the dog warden on Lammas Land, and a fixed penalty notice was subsequently issued and paid for breach of the dog control order.
- Two incidents of illegal advertising were identified; one on the railings by the Mill Pond and the other on Newnham Road, and were removed by the Council. Those responsible were first time offenders and received written warnings about illegal advertising.

Stray dogs (West/Central Area)

Area	Number of cases	Rehomed	Destroyed	Claimed	In Kennels	Comment
Castle	0	0	0	0	0	
Market	2	0	1	1	0	One other stray dog calls was received, but the dog was collected by the owner before the dog warden attended
Newnham	0	0	0	0	0	

Operations cleansing data by ward (West/Central Area)

Activity	Total number of incidents	Ward			Comments
		Castle	Market	Newnham	
Fly-tipping	32	3	22	7	
Offensive graffiti ⁴	8	2	3	3	
Detrimental graffiti ⁵	64	25	39	0	
Needles	19	2	17	0	
Shopping trolleys	3	1	3	1	Number of impounded trolleys was 1

Summary of cleansing data:

- Within the Market ward, there were four fly tips at Adam and Eve Street recycling centre, two incidents at Newmarket Road, Miltons Walk and Market Street. The majority of other locations had singular instances of fly tip. Of the seven cases of fly tips within Newnham, there were two instances at Kings Parade, The Fen Causeway and Kings Road the other reported fly tip was at Clerk Maxwell Road. No pattern of fly tipping was identified in Castel, and across the area no ongoing trends were established with these cases of fly tipping
- Out of the 8 cases of graffiti reported as offensive, there were five cases of swear words and/or sexual references, and three racist / religious drawings and/or references which was referred onto the Council's Community Safety Team.
- The West/Central area dedicated City Ranger continues to be proactive with the removal of graffiti from lampposts and communication boxes in these wards, in particular the Market and Newnham areas. All tags reported to the Council were cleared within the agreed time scales and no trends were identified.
- There were two used needles removed from St Giles Church in Castle following a call from the church warden. Seventeen used needles were removed from the Market Ward; one needle was removed at Burleigh House and one at Napier Street. A total of fifteen needles and a knife was removed from the church grounds at St Edward's Church over a number of different dates. Cambridgeshire Police are aware of this ongoing issue.

⁴ Offensive graffiti includes but is not limited to that which contains swear words, reference to religion, racist, reference to a person / naming a person, drawings of human body parts, words of reference to human body parts and reference to sexual activity. The service aim is to remove this type of graffiti within 1 working day.

⁵ Detrimental graffiti is graffiti that contains but is not limited to general tags, drawings not falling under the above criteria, and words not classified as offensive. The service aim is to remove this type of graffiti within 5 working days.

7. Proactive and community work

During the period January to March 2015 the following proactive and community work has been undertaken.

Task	Sign cleaning
Action Taken	The City Ranger for the West/Central area has been proactive cleaning traffic signs in and around the West/Central area and has recently completed cleansing of the Grange Road area. This is part of an ongoing programme of work that will be completed across the whole of the West/Central area.
Current Situation	Ongoing – part of a programme of work

Task	Graffiti removal
Action Taken	The City Rangers have been proactive in removing the small scale graffiti in and around the City Centre, and historic parts of the city particularly in Newnham and Market wards.
Current Situation	Ongoing – part of a programme of work

8. Key contacts

9. Area	Contact	Telephone Number	Email
Environmental Health Manager	Yvonne O'Donnell	01223 457951	yvonne.odonnell@cambridge.gov.uk
Pest Control Noise	Refuse and Environment	01223 457900	env.health@cambridge.gov.uk
Cleansing Manager			
Dog fouling	Customer Service Centre	01223 458282	wasteandstreets@cambridge.gov.uk
Litter			
Fly tipping (Public land)			
Graffiti			
Needles			
Public Realm Manager	Wendy Young	01223 458578	Wendy.young@cambridge.gov.uk
West/Central Ranger	Richard Allen	01223 458282	cityrangers@cambridge.gov.uk
City Centre Ranger	Chris Lowndes		
Abandoned bicycles	Customer Service Centre		
Public Realm Enforcement	Enforcement Team	01223 458573 01223 458062	streetenforcement@cambridge.gov.uk
Abandoned, untaxed and nuisance vehicles	Customer Service Centre	01223 458282	
Illegal camping Illegal advertising			
Dog Warden	Samantha Dewing (Mon-Wed)	01223 457883	dogwarden@cambridge.gov.uk
Stray and lost dogs	Customer Service Centre	01223 457900	
Out of Hours	Emergency calls	0300 3038389	n/a

10. Resources

The following are suggestions that members of the West/Central Area Committee and residents and businesses may wish to consider or request for the upcoming period:

Recycling and general street litter bins

A small quantity of recycling and general street litter bins are available for each ward, as follows:

Castle: 5 (5 bins used)

Market: 9

Newnham: 6 (1 bin used, 1 pending installation)

We would like to receive suggestions for where bins should be installed on the street and will investigate the suitability of all suggested locations. We will also be undertaking a review of where bins are currently installed to see how they are used.

At present we are in the second year of a three year replacement project for new and replacement bins on the city's streets and open spaces, and once the second phase is finished we will then run a similar scheme for new bins on the city's parks and open spaces.

Requested bins sites:

Ward	Location	Completion date
Newnham	Burrell's Walk (junction with Grange Road)	Scheduled for April to June 2015
<i>Newnham</i>	<i>Coton footpath (junction with Wilberforce Road)</i>	<i>March 2015</i>
<i>Castle</i>	<i>Howes Place (junction Huntingdon Road)</i>	<i>March 2015</i>
<i>Castle</i>	<i>Storey's Way (pedestrian traffic lights – junction with Huntingdon Road)</i>	<i>March 2015</i>
<i>Castle</i>	<i>Warwick Road (near Windsor Road alleyway)</i>	<i>March 2015</i>
<i>Castle</i>	<i>Carisbrooke Road (junction with Histon Road)</i>	<i>March 2015</i>
<i>Castle</i>	<i>Carisbrooke Road – near Mayfield School</i>	<i>March 2015</i>

*Bin installation requests that are not included in total available for each ward

Bins in italics installed in previous period

Example of bins used within the city:

For the outer city centre streets and shopping areas. Bins are installed wherever space allows with a recycling unit alongside:



For outer city shopping areas where space allows and areas on out city parks (for example Cherry Hinton Hall):



For the city centre, Market and Newnham wards:
Slim line general waste and recycling bins:



General waste and recycling bins:



Dog bin provision

A number of dog bins are available for each ward, as follows:

Castle: 2 (1 bin used)

Market: 3

Newnham: 0 (2 bins used)

We would like to receive suggestions for where bins should be installed on the parks and open spaces and will investigate the suitability of all suggested locations. We will also be undertaking a review of where bins are currently installed to see how they are used.

Requested bins sites:

Ward	Location	Completion date
<i>Newnham</i>	<i>Coton footpath (junction with Wilberforce Road)</i>	<i>March 2015</i>
<i>Newnham</i>	<i>Gough Way (near to Penarth Place)</i>	<i>March 2015</i>
<i>Castle</i>	<i>Storey's Way (pedestrian traffic lights – junction with Huntingdon Road)</i>	<i>Not a suitable location</i>
<i>Castle</i>	<i>Carisbrooke Road (near Histon Road junc)</i>	<i>March 2015</i>

Example of dog waste bins used for all sites:



Pocket ashtray distribution

Locations of where pocket ashtrays should be distributed from are welcomed by the Public Realm Enforcement team.

11. Appendices

Ward Blitz Activity – Castle – February 2015



The City Council has embarked on a campaign of ‘ward blitzes’ across the City, involving the Council’s City Ranger, Rapid Response, Public Realm Enforcement and Street Cleansing teams. These teams will undertake coordinated public realm maintenance, enforcement and educational action; this is additional to the routine, day-to-day, work undertaken by these services.

Ward blitz activities include:

- Cleansing of gully’s
- Cleansing of litter and dog bins
- Cleansing of signage
- Cleansing of recycling centres
- Increased dog warden presence
- Increased public realm enforcement presence
- Joint working with Cambridgeshire Fire and Rescue, and Cambridgeshire Police
- Free dog microchipping event

Castle was the fourth ward area to receive the targeted service during February 2015. A summary of the ward blitz action delivered in the month is detailed below:

Shop fronts deep clean	Shop fronts and associated street furniture were pressure washed at a number of locations that were included as part of the Cambridge BID contract within the City Centre during February, a number of these streets are included in the Castle ward.
Litter clearance	All footways within the ward have been cleared of litter and debris at least once a week during the blitz period.
Cleansing of recycling centres	All recycling sites within Castle were visited once in the month and have been pressure washed and also all of the footway surfaces pressure washed at these locations. Operations staff visited all recycling sites at least once a week to clear and dispose of any fly tipped items.
Graffiti removal	The graffiti teams proactively patrolled and cleared all graffiti, both offensive and detrimental, including an incident of offensive graffiti that was found at Honey Hill on council signage.
Sweeping of litter, detritus and leaves	A large mechanical sweeper was deployed to Castle and swept all carriageway gulleys (where not obstructed by parked vehicles) at least once in the month, and a mid-size mechanical sweeper with support from operatives swept footways and carriageways (where not obstructed by parked vehicles) at least once in the month with manual clearance of detritus to assist machine where required.

<p>Increased dog warden presence</p>	<p>The dog warden increased patrols in the green spaces of Castle, and was supported by patrols from the Enforcement team to deal with issues of dog fouling. Patrols included a mixture of early morning, daytime and weekend patrols.</p> <p>The following locations were visited:</p> <ul style="list-style-type: none"> • Histon Road Recreation Ground – 7 patrols • Shelly Road Recreation Ground – 4 patrols <p>In total the Dog Warden and Enforcement spent over ten hours patrolling the ward for dog control issues and providing education where required. No fixed penalties were issued for dog control breaches.</p> <p>The dog warden also visited 222 Victoria Road and spent time with the residents, providing educational advice and dog poo bags.</p>
<p>Increased public realm enforcement presence</p>	<p>The public realm enforcement team carried out over 34 hours of hi-visibility patrols in the ward during February, including the following specific issues:</p> <ul style="list-style-type: none"> • At Storeys Way, a hot spot for untaxed vehicles, the taxation status of vehicles were checked along the whole length of the road on multiple occasions. • Illegally advertised posters were removed from Castle Hill and Madingley Road, the latter of which resulted in a warning letter being issued to the suspect. • At Shelly Gardens and Honey Mews, three illegally positioned estate agent boards were removed and disposed of. • Three cases of small scale fly tipping were found and investigated in the ward, which resulted in two fixed penalty was issued for littering waste at Bridge Street and Castle Hill. • Over 10 hours of litter patrols were conducted and this resulted in two fixed penalties for littering, one for dropping a cigarette end on Bridge Street and the other for throwing a cigarette end from a motor vehicle on Madingley Road.
<p>Increased city ranger presence</p>	<p>The city ranger carried out a amount of hi-visibility work in the ward during February, including the following specific issues:</p> <ul style="list-style-type: none"> • Sign cleaning at Brownlow Road • Multiple graffiti removal at Huntingdon Road • Sticker removal on Castle Street • Sweeping cycle parking clear of gravel in front of Iceland store • In depth litter pick of Histon Road recreation ground and surrounding areas • Shrub cut at Chatsworth Avenue

Photographs of Northampton Street: Before and after City Ranger clean up (January 2015)



Photographs of Victoria Avenue: Before and after City Ranger clean up (January 2015)



Photographs of Hoadley Road: Before and after City Ranger cut back (January 2015)



Page 58



Photographs of Lammas Land: Before and after City Ranger involvement (February 2015)

Page 59



Photographs of Selwyn Road: Before and after City Ranger cut back (February 2015)



Page 60

Photographs of Chatsworth Avenue: Before and after City Ranger cut back (February 2015)



Page 61

Photographs of Driftway: Before and after City Ranger cut back (March 2015)



Page 62

Photographs of Herschel Road: Before and after City Ranger clean up (March 2015)



This page is intentionally left blank